

Dimensions Studio
 Surface studio floor = 3000m²
 Surface without pool = 2125m²
 Surface pool = 0875m²
 Dimensions Studio Doors = 4m00W x 4m20H

Dimensions Beams Studio
 Height to bottom (main beam) = 20m10
 Distance between beams = 10m80

Loading Figures Studio
 Max allowed floorpressure = 1000kg/m²

Main beams (spacing = 10m80)
 Max. qload/beam = 500kg/m
 Max allowed point load (CPL) = 10000kg/beam
 Max 6 load/beam = 2500kg/m
 !!! Rigging only possible with beamclamps on corner beam !!!

Sub beams (spacing = 5m00)
 Max qload/beam = 230kg/m
 Max allowed point load (CPL) = 1500kg/beam
 Please refer to "Calculation Document" for accurate loading figures

Electrical Power
 3 x 400A Powerlock connection
 4 x CEE125A connection 5p (3PH+N+E)
 4 x CEE32A connection 5p (3PH+N+E)
 Main Circuit board

Pool
 Length = 35m00
 Width = 25m00
 Depth (till bottom) = 04m05
 Normal water level = 03m80
 Max water temperature = 29°C
 Filtration System = 250m³/h

Other Information:
 The studio is equipped with a floor heating system (1600m²)
 and 2 HVAC systems (pulsion @ 8m00 / Extraction @ 4m00)

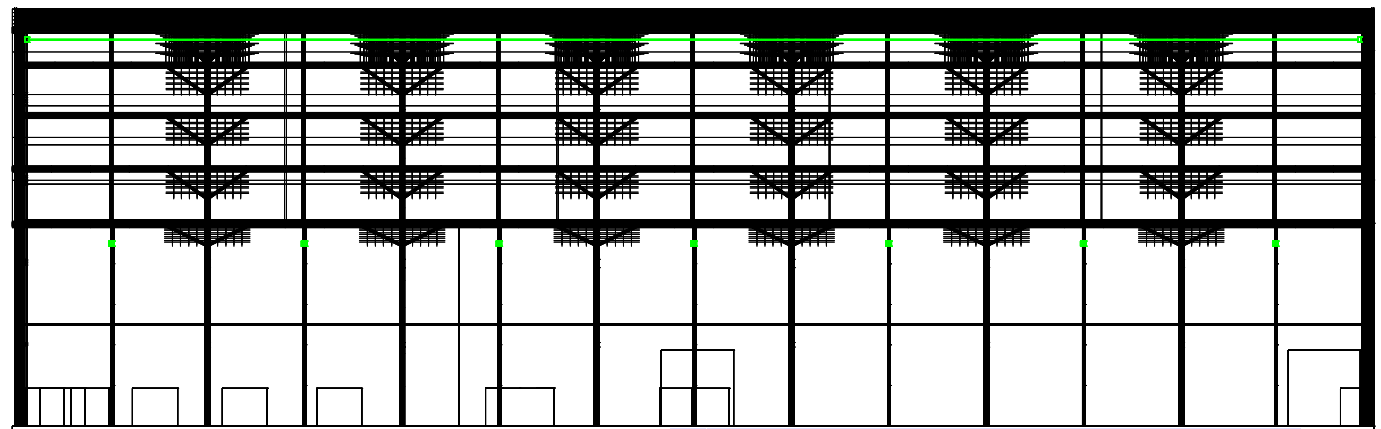

 <div>AED Studios Fabriekstraat 38 2547 Lint Belgium www.aedstudios.com</div>	Studio/Room		Papersize A3
	Studio 12		Units [mm]
	Plan type	Overview	Scale 1:300
			Version V1